



Installation Instructions

Parts

- 1- Aqua Staircase and Deck Mount(1)
- 2- Hand Rail(1)
- 3- Bolts, Nuts, Flat Washers (4 Each)
- 4- Snap Caps - White (4 Each)
- 5- Mesh Ballast Bags (King 3, Duke 2)
- 6- Deck Mount Screws (5-1 1/2", 2-1")

WARNING

This product is designed for POOL USE ONLY! Keep this product free from Algae by forcing water through the vent openings. Improper installation may result in damage to your pool liner.

THE MANUFACTURER IS NOT RESPONSIBLE FOR DAMAGE CAUSED BY FAULTY INSTALLATION.

Thank you for purchasing one of the finest pool steps available today. With proper installation and care your Aqua Staircase will give you years of trouble free service. It is recommended that a step pad be used between step and liner.

INSTALLATION

1. Lay your Step on its back as shown.

Remove the handrail and hardware pack from inside the step through the arched vent hole in the BOTTOM of the step.

Note: For the King step, remove thru oval hole in back of step.

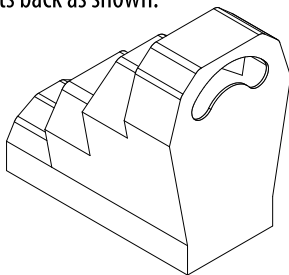

2. Locate the four (4) handrail bolts and white snap caps.

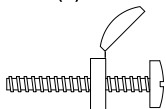

Place the white snap cap on each railing bolt before pushing through the step and rail in step 3.

Care and Maintenance

Your step is virtually maintenance free. Periodic brushing will help deter algae growth.

3. Insert the deck mount onto the handrail(s) then insert the rail into the 2" pre drilled holes on the step. Align the 1/4" pre drilled holes in the rail with the corresponding holes drilled in the side

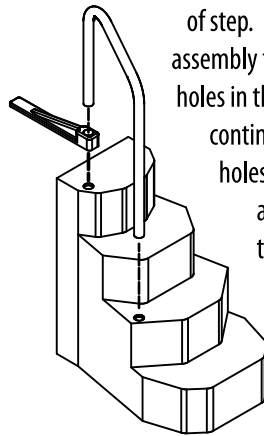

of step. Insert the bolt assembly through the guide holes in the side of the step continuing through the holes in the rail. Place a flat washer and thread a nut on the opposite end of each bolt. Hand-tighten.

4. Insure the rail is properly aligned then tighten the nuts to hold the rail securely in place. Cover the head of the bolts with the white snap caps.

5. Using COURSE PRE-WASHED GRAVEL, ROUNDED STONES or SAND, fill each custom Aqua Staircase mesh bag and secure the Velcro tops.

IT IS HIGHLY RECOMMENDED THAT YOU HAVE ADDITIONAL PEOPLE HELP YOU PERFORM THE NEXT STEP – POSITIONING THE STEP INSIDE THE POOL. NEVER GET BENEATH THE STEP OR BETWEEN THE WALL AND STEP! AVOID BECOMING ENTRAPPED AS IT COULD PRESENT A DROWNING HAZARD! IMPORTANT - INSPECT BOTTOM OF STEP FOR ANY ROUGH AREAS WHICH MAY HAVE DEVELOPED DURING SHIPPING OR TRANSPORTATION OF THE STEP TO YOUR HOME. SMOOTH ANY ROUGH AREAS WITH MEDIUM GRIT SANDPAPER BEFORE INSTALLING INTO THE POOL.

6. Move the step near its intended location. Carefully lift the step into the pool. Although it is not necessary a step pad can be placed under the step. It is normal for step to float initially. As the air escapes around the railing holes the step will settle to the bottom of the pool. As the step is settling, add the filled ballast bags through the access holes in the rear of the step.

King Step includes 3 mesh bags.

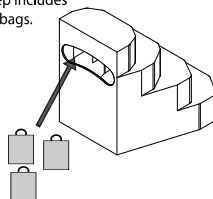

Duke Step includes 2 mesh bags.

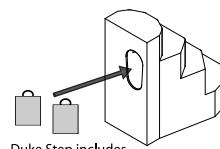

7. Move the step into place tight against the wall. NEVER GET BENEATH THE STEP OR BETWEEN THE WALL AND STEP! AVOID BECOMING ENTRAPPED AS IT COULD PRESENT A DROWNING HAZARD!

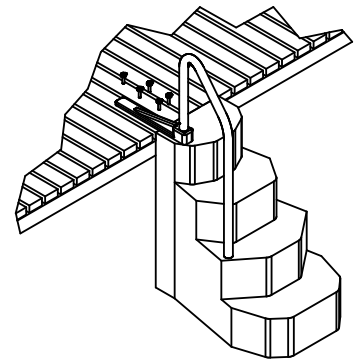

8. Attach deck mount to the deck using the (5) 1-1/2" screws. Attach the deck mount to the rail using the (2) 1" self tapping screws.

9. If the top step is lower than the deck, the mount should be shimmed. Secure the shim to the deck mount with stainless steel screws (not-provided) then secure the mount to the deck with the screws provided. (Fig. 9)

10. If the top step is higher than the pool deck, the mount should be shimmed. Secure the shim to the deck with stainless steel screws (not-provided) then secure the mount to the shim with the screws provided. (Fig. 10)

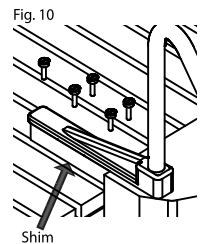
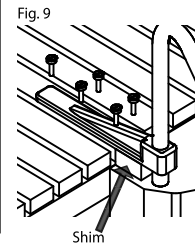

IMPORTANT - DANGER

- NO DIVING OR JUMPING OFF STEPS!
- ONE PERSON AT A TIME ON THE POOL STAIRCASE.
- DO NOT GET BENEATH THE STEP OR BETWEEN STEP & WALLS OF POOL. AVOID BECOMING ENTRAPPED AS IT COULD PRESENT A DROWNING HAZARD!
- DO NOT USE ELECTRICAL TOOLS TO INSTALL STEPS. USE BATTERY POWERED TOOLS ONLY!
- STEPS MUST SET FLAT ON BOTTOM OF POOL!
- LOCATE IN-POOL STAIRCASE ON A SOLID BASE.
- THE IN-POOL STAIRCASE SHALL BE INSTALLED PER MANUFACTURER'S INSTRUCTIONS.

Merlin Industries, Inc.
2904 East State Street Ext.
Hamilton, NJ 08619
www.merlinindustries.com