

# ASSEMBLY INSTRUCTIONS



## Assembly Instructions for F2173 Picnic Table (10 FT.)

To prevent scratching on any of the finished pieces, we recommend assembling the unit on packing material (paper and cardboard). Do not drag assembled unit on any surface. The assembly is a two person operation.

### Cleaning Recommendations

For cleaning, use mild household cleansers or soap and water.  
Do not use vinyl cleansers or protectants.

### Parts List

- 1 – Table Top
- 2 – Seats
- 2 – End Supports
- 1 – Center Support
- 4 – Cross Braces

### Hardware Included

- 26 – 5/16” Bolts
- 26 – 5/16” Nuts
- 52 – Washers
- 6 – Rubber Feet

### Tools Needed

- Ratchet with 1/2” socket
- 1/2” Wrench
- Level
- Rubber Mallet

Table Top

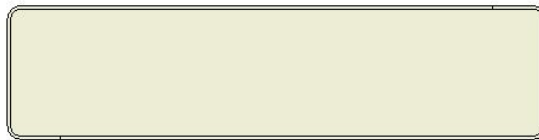

Seats

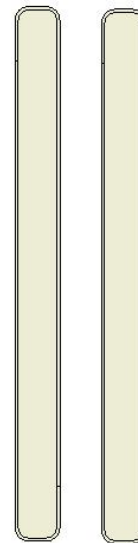

End Supports

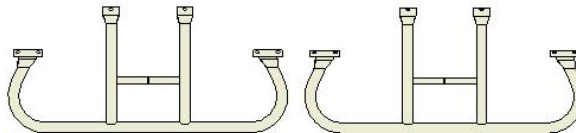

Center Support

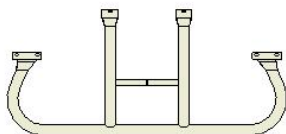

Cross Braces

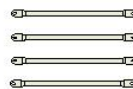

211 N. Lindbergh Blvd. • St. Louis, MO 63131-7809  
800-231-1327 • [www.landscapebrands.com](http://www.landscapebrands.com)

# ASSEMBLY INSTRUCTIONS

Landscape  
**FUSION**™

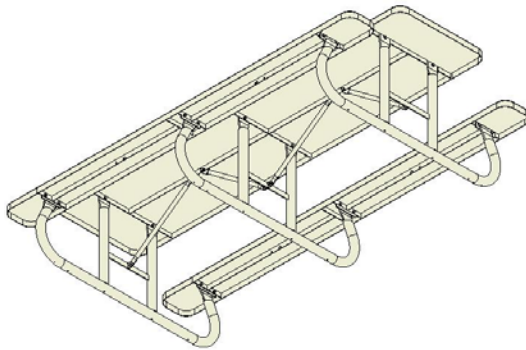

**Diagram #1**

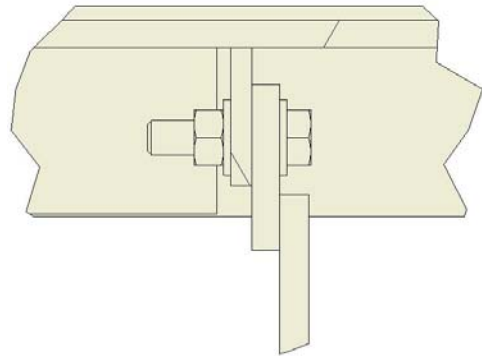

**Diagram #2**

Note: Before assembling the nuts to the bolts, it is recommended that a light oil or petroleum jelly be applied to the bolt threads.

1. Place table top upside down on a level surface.
2. Align end support holes and center support holes with table top holes, as shown in Diagram #1.
3. Place bolts through holes and attach nuts to bolts, leaving nuts finger tight, with washers on both sides, as shown in Diagram #2
4. Align cross brace holes with center table top holes and the tab holes on the end supports and center supports.
5. Place bolts through holes and attach nuts to bolts, leaving nuts finger tight, with washers on both sides, as shown in Diagram #2.
6. Using the rubber mallet, insert the rubber feet in the outermost holes of the table supports.
7. Turn table right side up.
8. Level table top
9. Repeat steps 2 and 3 for seats.
10. Level seats.
11. Tighten all hardware. Retighten hardware two weeks after initial assembly.